

#MAZ1BGLH - sgl bangle w/accent & magnet barabd base

1. Glue up barabd to required height. Cut into $3\frac{3}{16}$ "W x $1\frac{7}{8}$ "D.
2. Cut top surface to 25° angle w/back measuring $1\frac{1}{2}$ "Ht and front $\frac{3}{8}$ "Ht (front measurement for reference only)
3. Dado center groove $1\frac{1}{16}$ " wide
4. Make saw cut in center rear. Hold for further assembly.

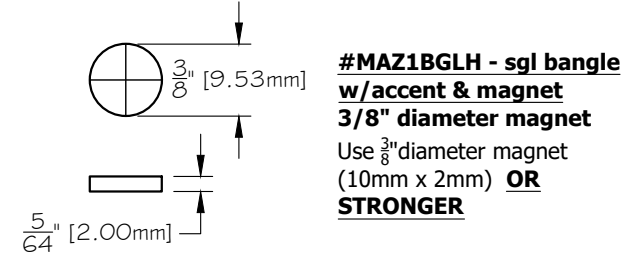

#MAZ1BGLH - sgl bangle w/accent & magnet 3/8" diameter magnet
Use $\frac{3}{8}$ " diameter magnet (10mm x 2mm) OR STRONGER

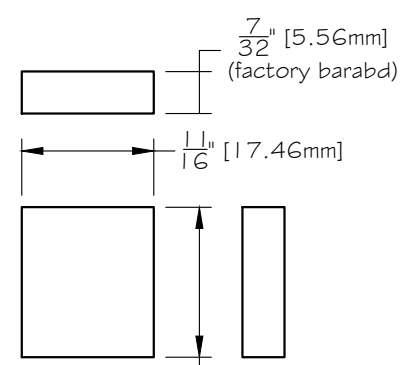

#MAZ1BGLH - sgl bangle w/accent & magnet 1/4" barabd channel plugs
qty: 2 per display
Cut (2) pcs of $\frac{1}{4}$ " barabd into $1\frac{1}{16}$ "W x $\frac{3}{32}$ "D. Hold for assembly.

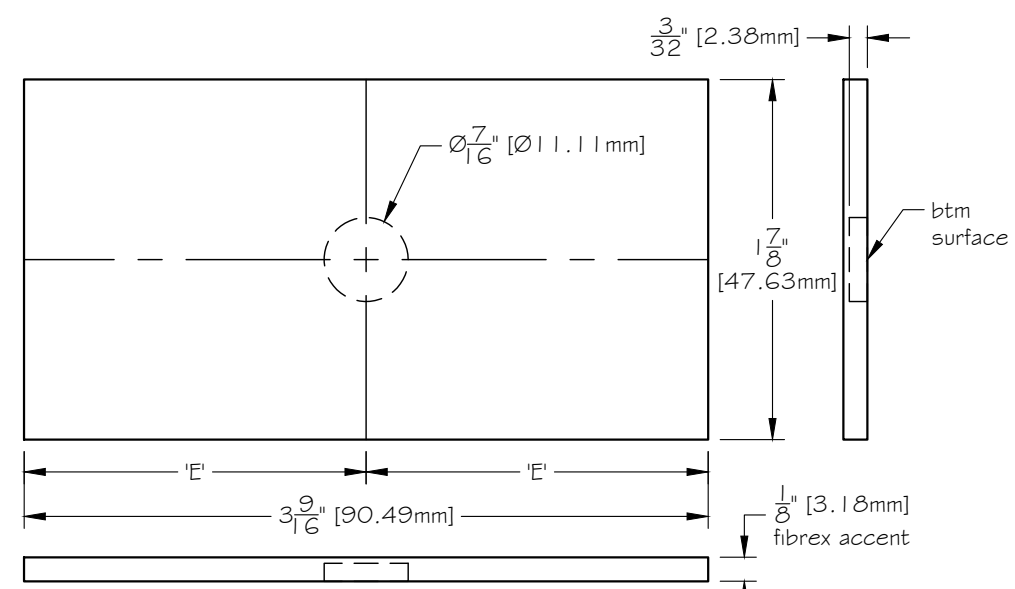

#MAZ1BGLH - sgl bangle w/accent & magnet 1/8" fibrex accent
Cut $\frac{1}{8}$ " fibrex into $3\frac{3}{16}$ "W x $1\frac{7}{8}$ "D. Drill single $\frac{7}{16}$ " Diameter x $\frac{3}{32}$ "D circle in btm center. Strip Cover in Ebony Dore fabric, leaving drilled circle on btm exposed. Hold for assembly.

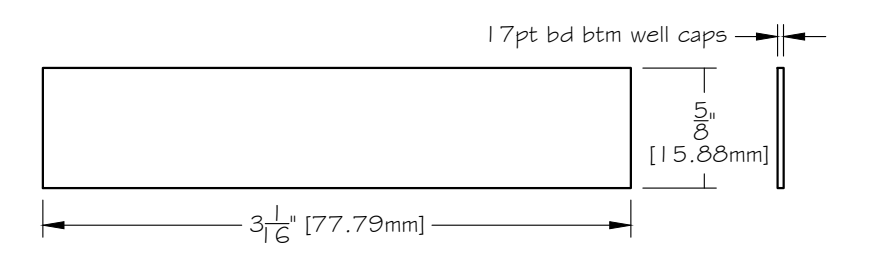

#MAZ1BGLH - sgl bangle w/accent & magnet 17pt btm well caps
Die-cut 17pt bd into $3\frac{1}{16}$ "W x $\frac{1}{8}$ "D. Hold for assembly.

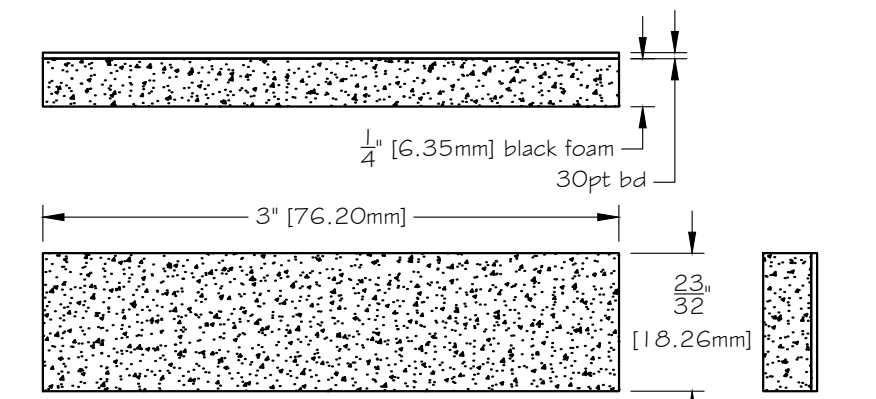

#MAZ1BGLH - sgl bangle w/accent & magnet 30pt bd + 1/4" black foam stuffing
qty: 2 per display
Laminate $\frac{1}{4}$ " black foam to 30pt bd. Cut into 3"W x $\frac{3}{32}$ "D strips. Cover top down, leaving left/right sides raw. See below for pictorial. Hold for assembly.

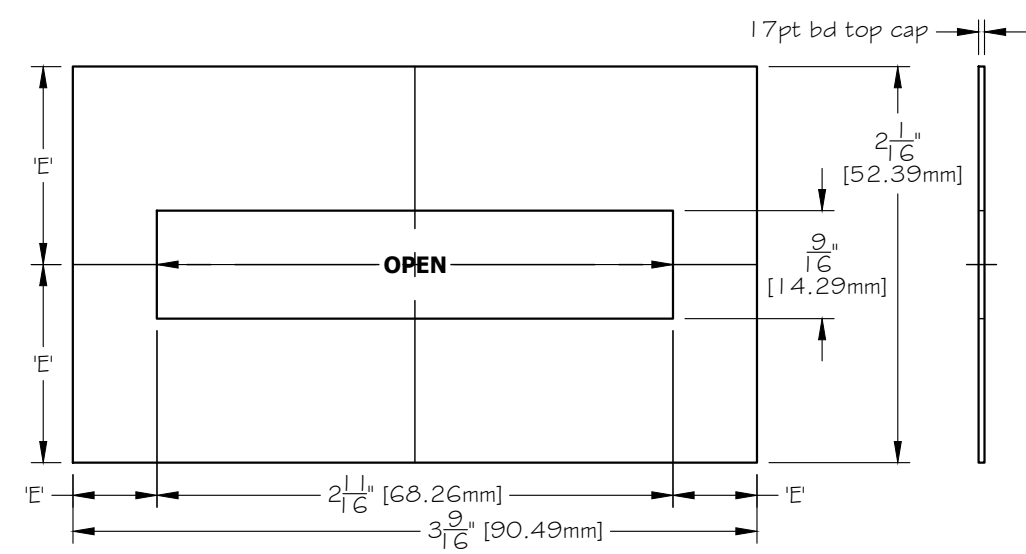
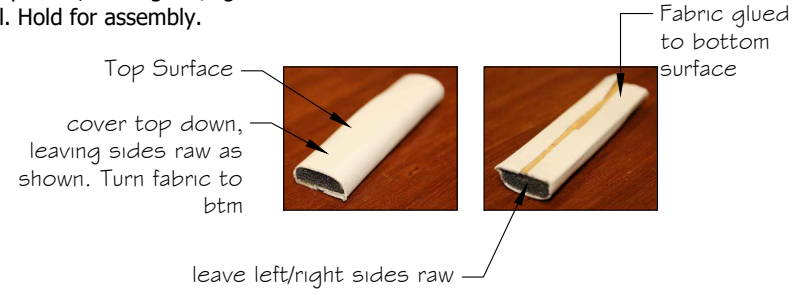

#MAZ1BGLH - sgl bangle w/accent & magnet 17pt bd top cap
Die-cut 17pt bd to $3\frac{3}{16}$ "W x $2\frac{1}{16}$ "D with $2\frac{1}{16}$ "W x $\frac{9}{16}$ "D bangle slot in location indicated above. Cover top down in fabric turning fabric into slot and btm of cap. Hold for assembly.

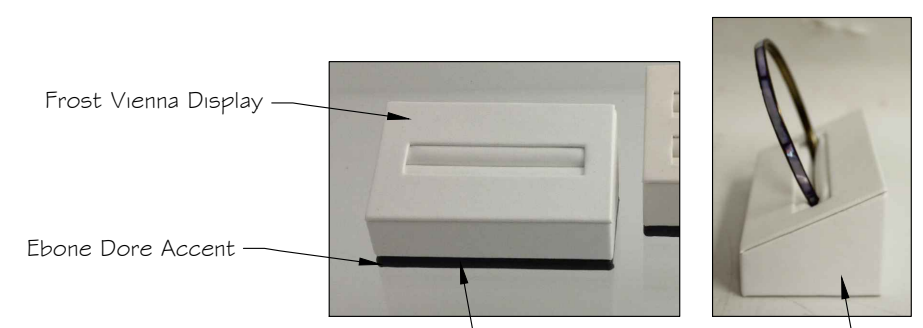

#MAZ1BGLH - sgl bangle w/accent & magnet finished dimension: 3 3/16" W x 2" D x 1 7/8" Ht

1. Centering all around, permanently glue covered top cap to top of covered barabd base.
2. Centering all around, permanently glue covered fibrex accent to btm of covered barabd base.
3. Permanently glue magnet into btm of accent in drilled circle, making sure magnet is flush to btm surface and not bulging out.
4. Finish with label paper laminated on 17pt bd on btm.

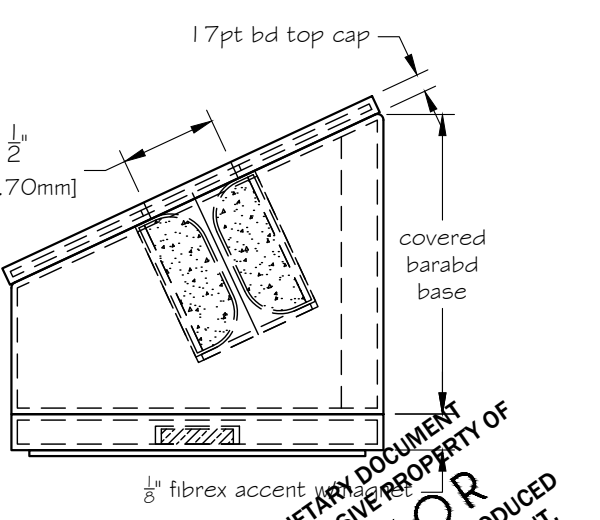
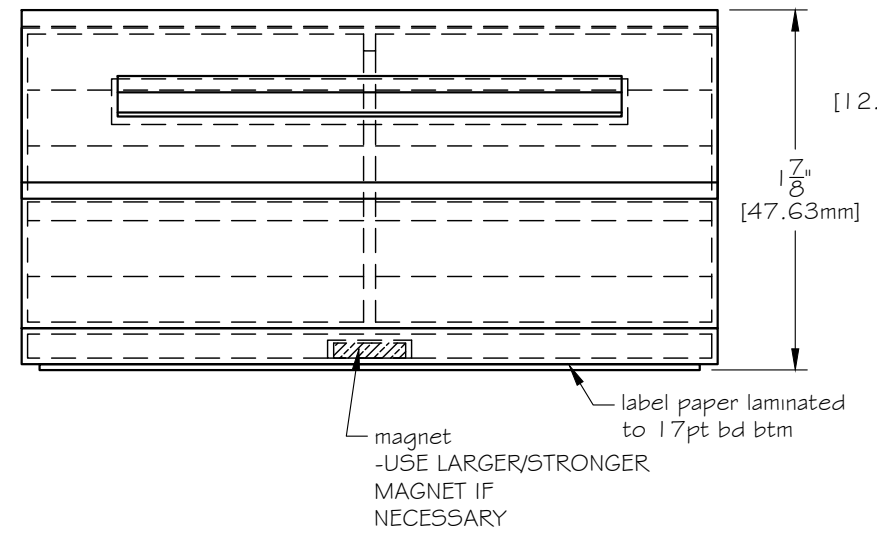
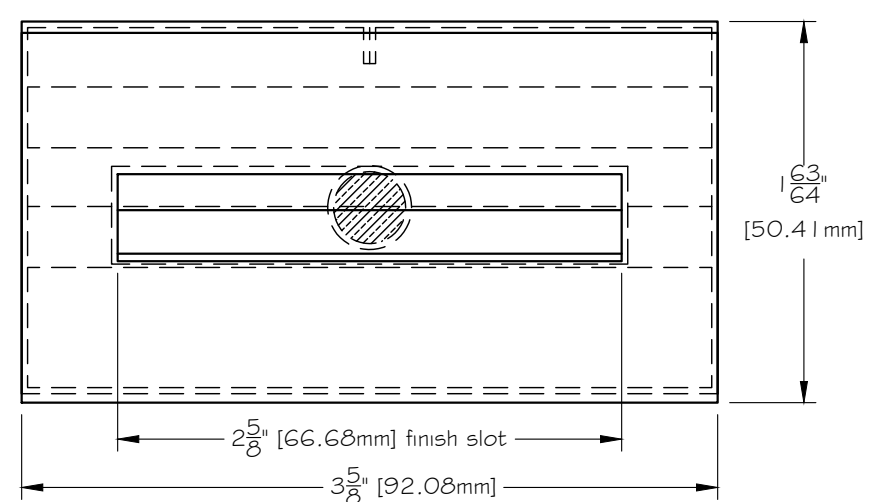

PROPRIETARY DOCUMENT
DESIGN EXCLUSIVE PROPERTY OF
BUFKOR
DESIGN NOT TO BE REPRODUCED
WITHOUT WRITTEN CONSENT.

All dimensions listed are raw. Test all pieces for correct fit and function. **Todas las medidas dadas son crudas. Probar todas las piezas para encaje y funcionamiento correcto.**

BARABD BASE ASSEMBLY

#MAZ1BGLH - sgl bangle w/accent & magnet base assembly

1. On the left side of open channel in barabd base, glue $\frac{1}{4}$ " barabd plug into channel. Repeat same process on right side of barabd base.
2. Sand barabd plug and barabd base so top surfaces are flush. Same for the sides.
3. Permanently glue 17pt btm well cap into channel.
4. Strip cover base in fabric, tucking fabric into saw cut and turning fabric to top & btm surfaces.
5. Place (2) pcs of covered stuffing into wells. No glue is required. See at right for further assembly.

PURPOSE: PRODUCTION DRAWING	SHEET OF 1 OF 3
DESCRIPTION: MAZUCCHELLIS MAZ1BGLH - SGL BANGLE W/ACCENT	DRAWING #: 15762
CUSTOMER, ADDRESS OR LOCATION: THE JEWELLERY GROUP	SCALE: 1" = 1"
STORE PLANNING AND CUSTOM DESIGN SERVICE	DATE: 09/22/14
BUFKOR — quality since 1895 —	SALESMAN: SJ
EXECUTIVE OFFICES: 13101 56th COURT NORTH STE. 815 CLEARWATER, FLORIDA 33760 © 2014 BUFKOR INC.	DRAWN BY: SS

NOTICE: ALL PROPRIETARY DOCUMENT (INCLUDING ITS CONTENTS, IN WHOLE OR IN PART) IS LOANED TO BAILEE ON CONDITION THAT IT BE RETURNED ON DEMAND, AND THAT NO USE OR DISCLOSURE TO ANOTHER OR REPRODUCTION IN WHOLE OR IN PART, BE MADE OF IT, WITHOUT PRIOR WRITTEN PERMISSION BY A DULY AUTHORIZED OFFICER OF BUFKOR, INC., ITS EXCLUSIVE OWNER AND BAILEE.

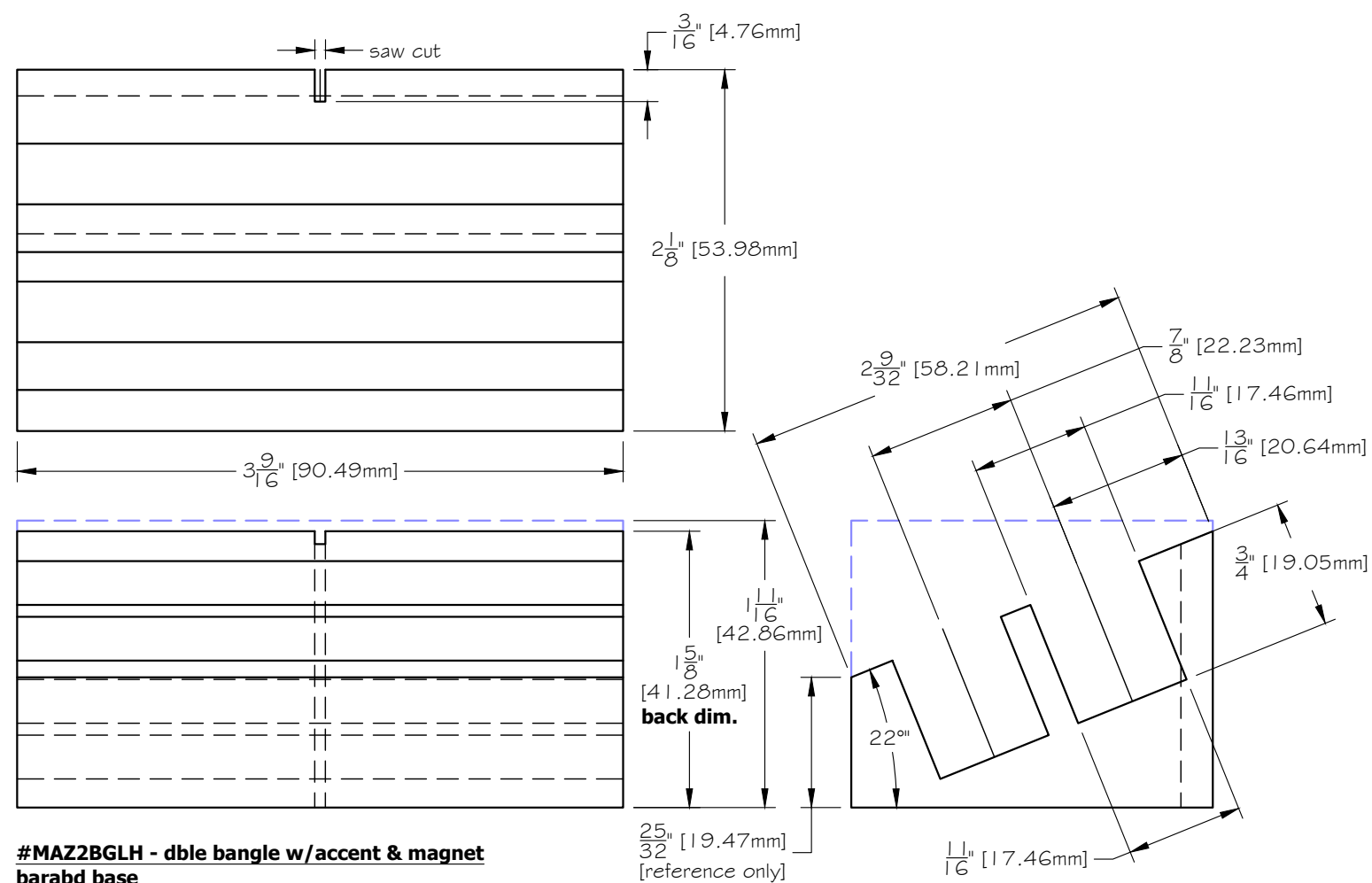

#MAZ2BGLH - dble bangle w/accent & magnet barabd base

1. Glue up barabd to required height. Cut into $3\frac{3}{16}$ "W x $2\frac{1}{8}$ "D.
2. Cut top surface to 22° angle w/back measuring $1\frac{5}{8}$ "Ht and front $\frac{3}{32}$ "Ht (front measurement for reference only)
3. Dado center grooves $\frac{1}{16}$ " wide each
4. Make saw cut in center rear. Hold for further assembly.

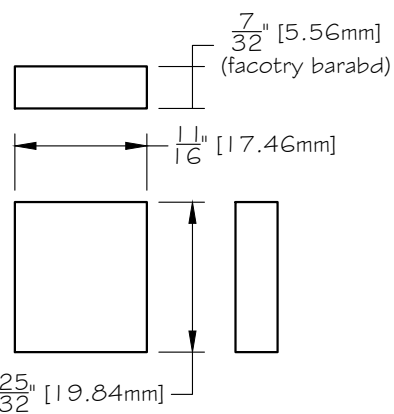

#MAZ2BGLH - dble bangle w/accent & magnet 1/4" barabd channel plugs

- qty: 4 per display
Cut (2) pcs of $\frac{1}{4}$ " barabd into $\frac{1}{16}$ "W x $\frac{3}{32}$ "D. Hold for assembly.

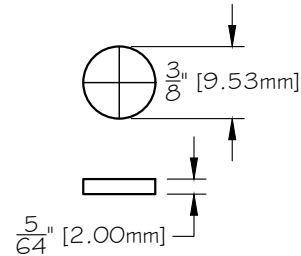

#MAZ2BGLH - dble bangle w/accent & magnet 3/8" diameter magnet

- Use $\frac{3}{8}$ " diameter magnet (10mm x 2mm) **OR STRONGER**

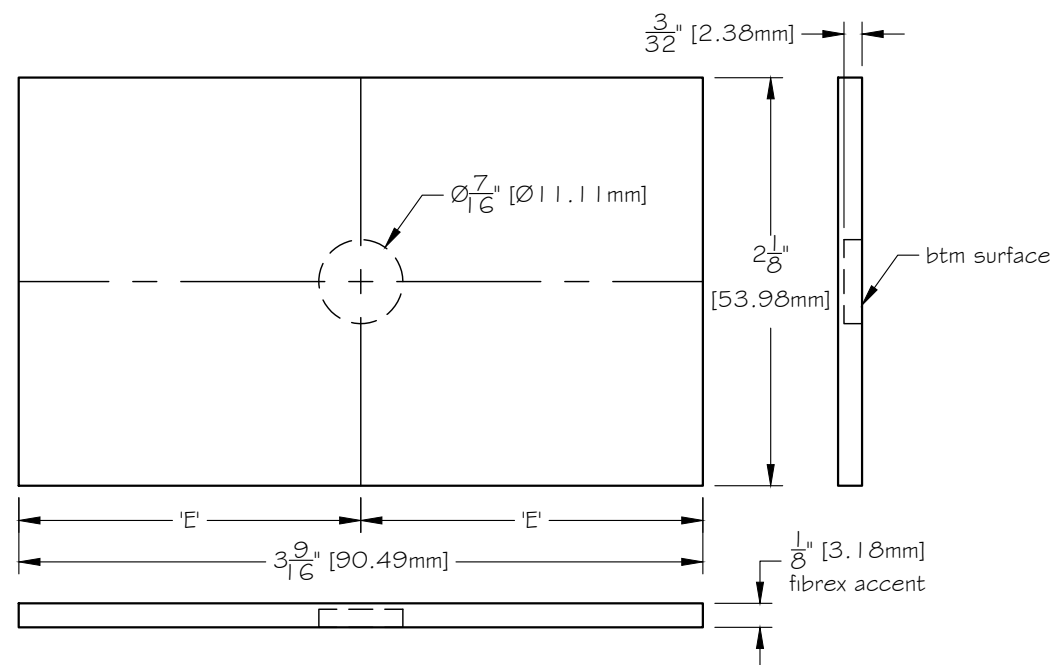

#MAZ2BGLH - dble bangle w/accent & magnet 1/8" fibrex accent

- Cut $\frac{1}{8}$ " fibrex into $3\frac{3}{16}$ "W x $2\frac{1}{8}$ "D. Drill single $\frac{7}{16}$ " Diameter x $\frac{3}{32}$ "D circle in btm center. Strip Cover in fabric, leaving drilled circle on btm exposed. Hold for assembly.

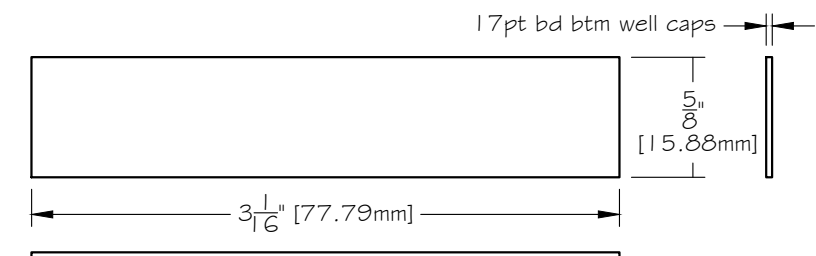

#MAZ2BGLH - dble bangle w/accent & magnet 17pt btm well caps

- qty: 2 per display
Die-cut 17pt bd into $3\frac{1}{16}$ "W x $\frac{5}{16}$ "D. Hold for assembly.

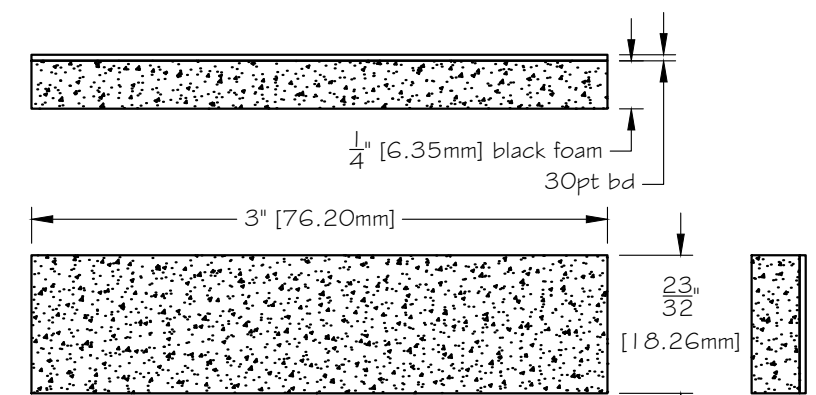

#MAZ2BGLH - dble bangle w/accent & magnet 30pt bd + 1/4" black foam stuffing

- qty: 4 per display
Laminate $\frac{1}{4}$ " black foam to 30pt bd. Cut into 3"W x $\frac{3}{32}$ "D strips. Cover top down, leaving left/right sides raw. See below for pictorial. Hold for assembly.

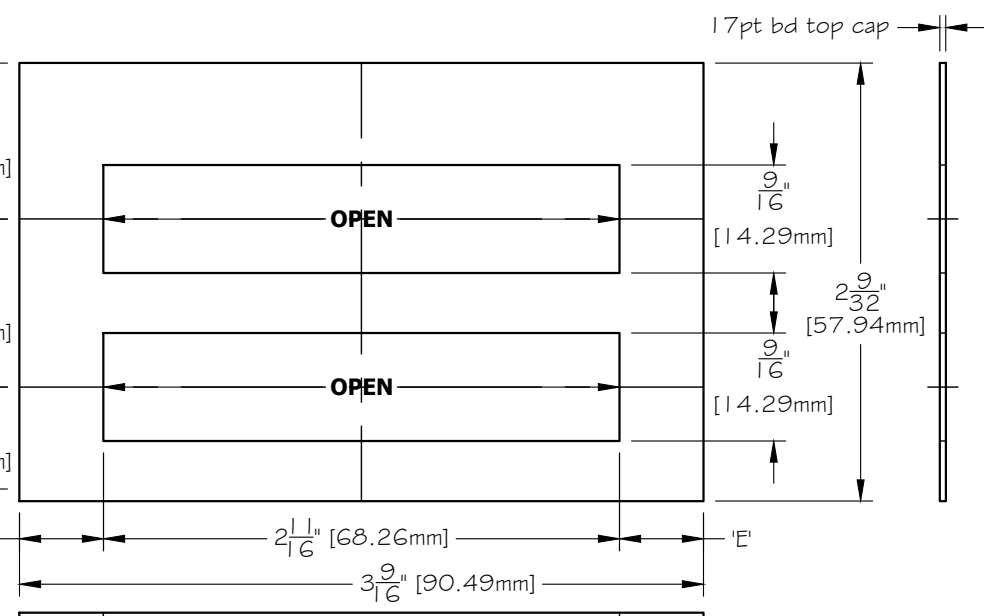
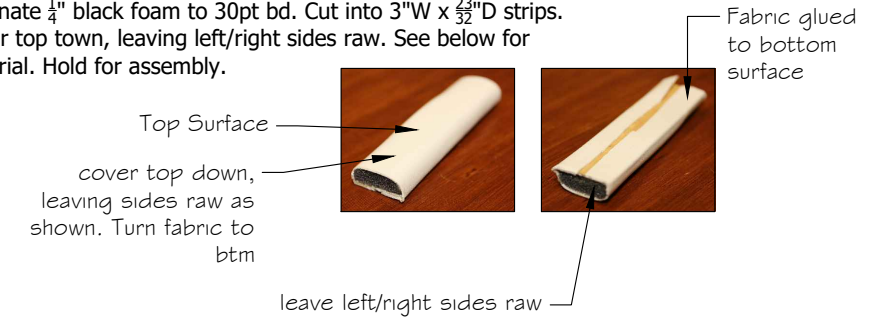

#MAZ2BGLH - dble bangle w/accent & magnet 17pt bd top cap

- Die-cut 17pt bd to $3\frac{3}{16}$ "W x $2\frac{1}{8}$ "D with (2) $2\frac{1}{8}$ "W x $\frac{1}{16}$ "D bangle slots in location indicated above. Cover top down in fabric turning fabric into slots and btm of cap. Hold for assembly.

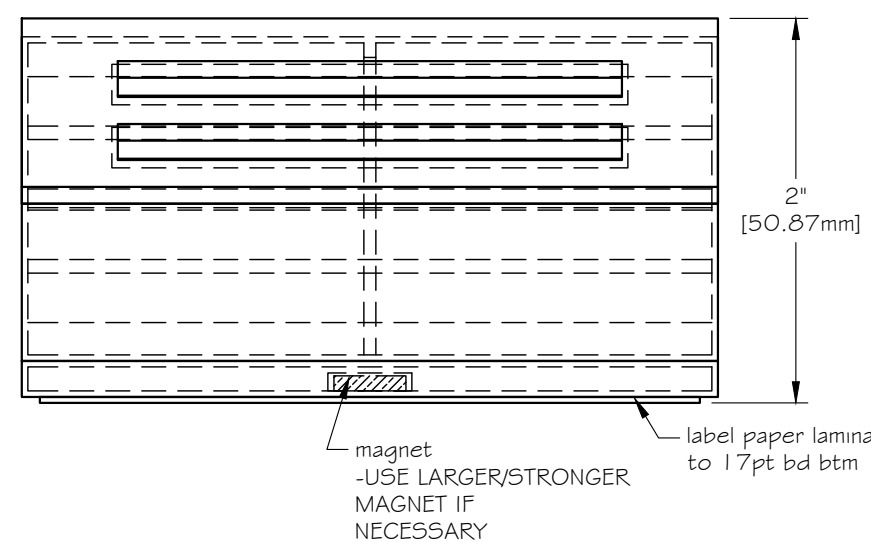
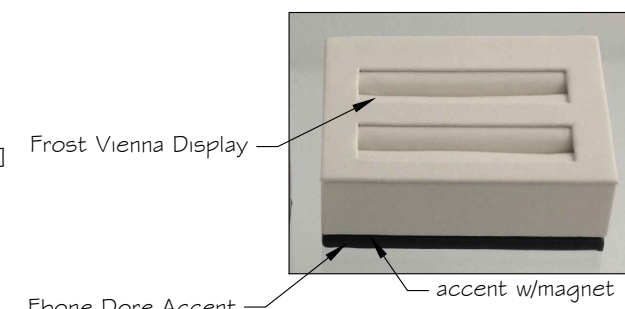
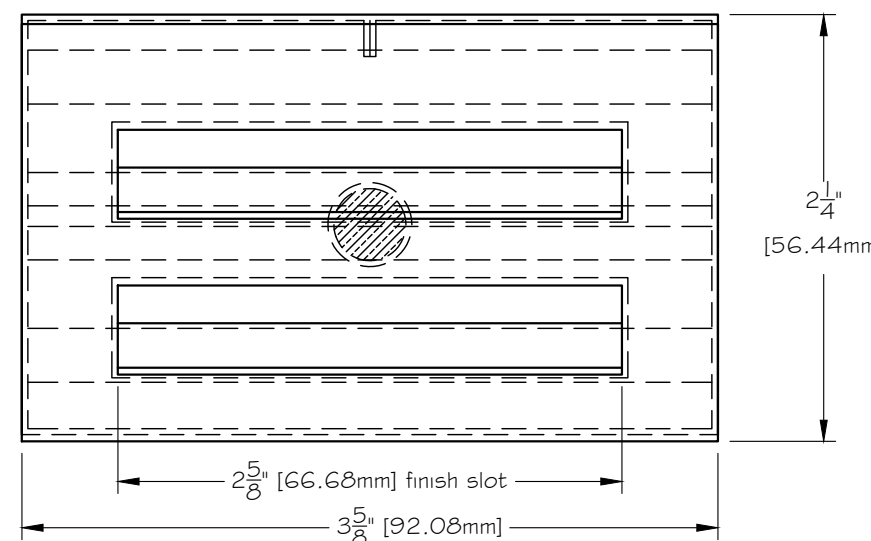

#MAZ2BGLH - dble bangle w/accent & magnet finished dimension: 3 3/8" W x 2" D x 2" Ht

- (See page 1 of 1 for barabd base assembly)
1. Centering all around, permanently glue covered top cap to top of covered barabd base.
 2. Centering all around, permanently glue covered fibrex accent to btm of covered barabd base.
 3. Permanently glue magnet into btm of accent in drilled circle, making sure magnet is flush to btm surface and not bulging out.
 4. Finish with label paper laminated on 17pt bd on btm.

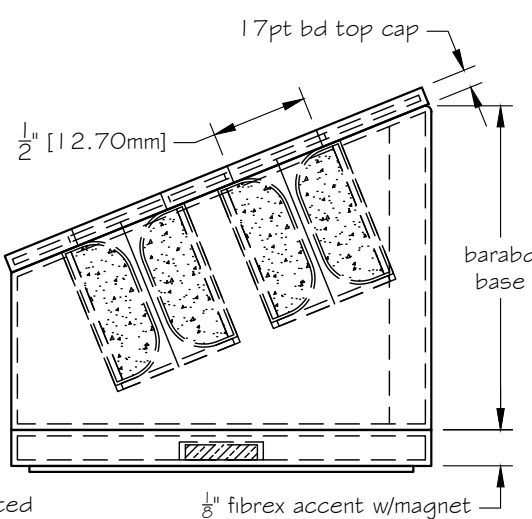

All dimensions listed are raw. Test all pieces for correct fit and function. Todas las medidas dadas son crudas. Probar todas las piezas para encaje y funcionamiento correcto.

PURPOSE: PRODUCTION DRAWING	SHEET OF 2 OF 3
DESCRIPTION: MAZZUCHELLIS MAZ2BGLH - DBL BANGLE W/ACCENT	DRAWING #: 15762
CUSTOMER, ADDRESS OR LOCATION: THE JEWELLERY GROUP	SCALE: 1" = 1"
STORE PLANNING AND CUSTOM DESIGN SERVICE	DATE: 09/22/14
EXECUTIVE OFFICES: 13101 56th COURT NORTH STE. 815 CLEARWATER, FLORIDA 33760 © 2014 BUFKOR INC.	SALESMAN: SJ
	DRAWN BY: SS

NOTICE: ALL PROPRIETARY DOCUMENT (INCLUDING ITS CONTENTS, IN WHOLE OR IN PART) IS LOANED TO BAILEE ON CONDITION THAT IT BE RETURNED ON DEMAND, AND THAT NO USE OR DISCLOSURE TO ANOTHER OR REPRODUCTION IN WHOLE OR IN PART, BE MADE OF IT, WITHOUT PRIOR WRITTEN PERMISSION BY A DULY AUTHORIZED OFFICER OF BUFKOR, INC., ITS EXCLUSIVE OWNER AND BAILEE.

PROPRIETARY DOCUMENT
DESIGN EXCLUSIVE PROPERTY OF
BUFKOR
DESIGN NOT TO BE REPRODUCED
WITHOUT WRITTEN CONSENT.

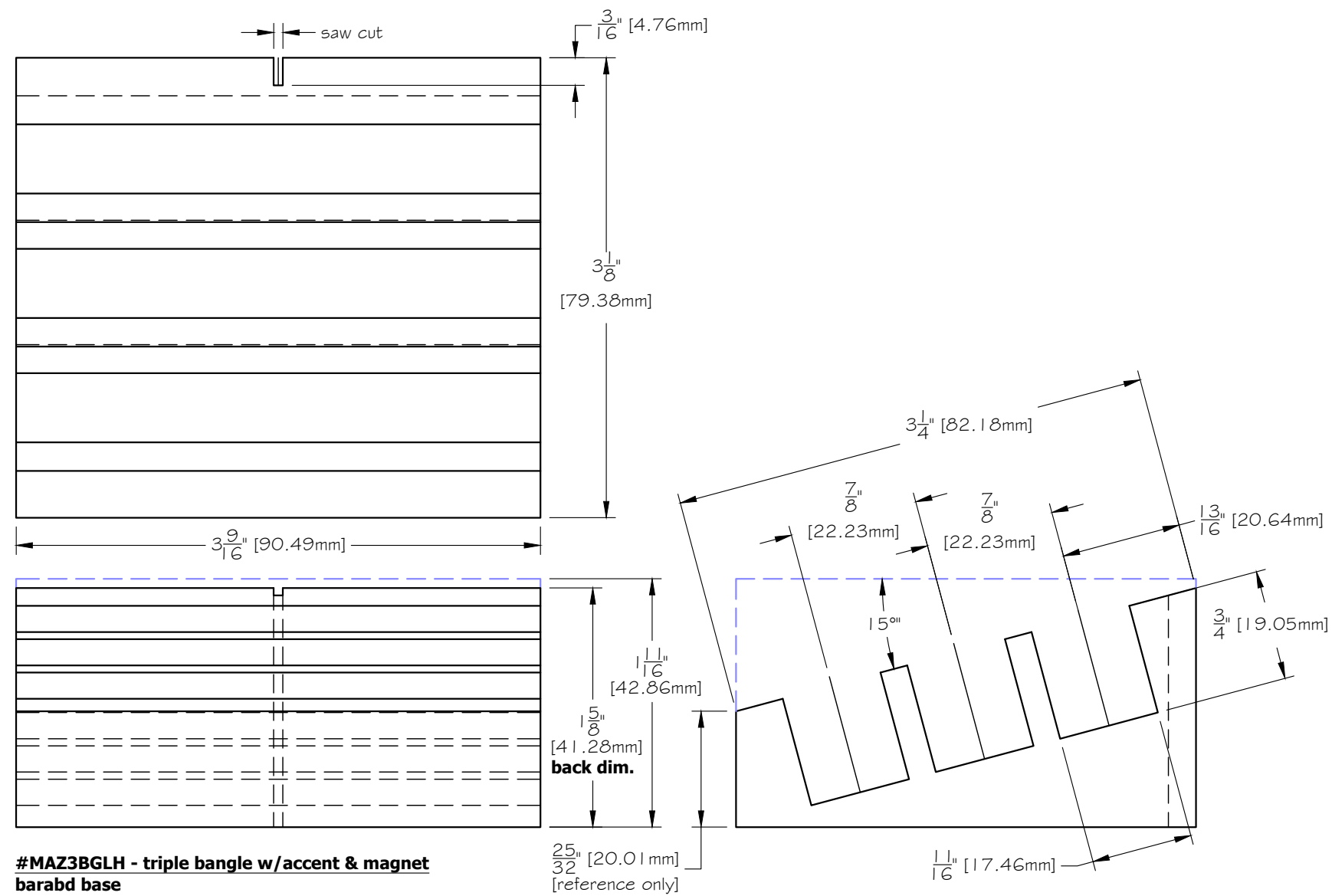

#MAZ3BGLH - triple bangle w/accnt & magnet barabd base

1. Glue up barabd to required height. Cut into $3\frac{9}{16}$ "W x $3\frac{1}{8}$ "D.
2. Cut top surface to 15° angle w/back measuring $1\frac{5}{8}$ "Ht and front $\frac{39}{32}$ "Ht (front measurement for reference only)
3. Dado center grooves $\frac{1}{16}$ " wide each
4. Make saw cut in center rear. Hold for further assembly.

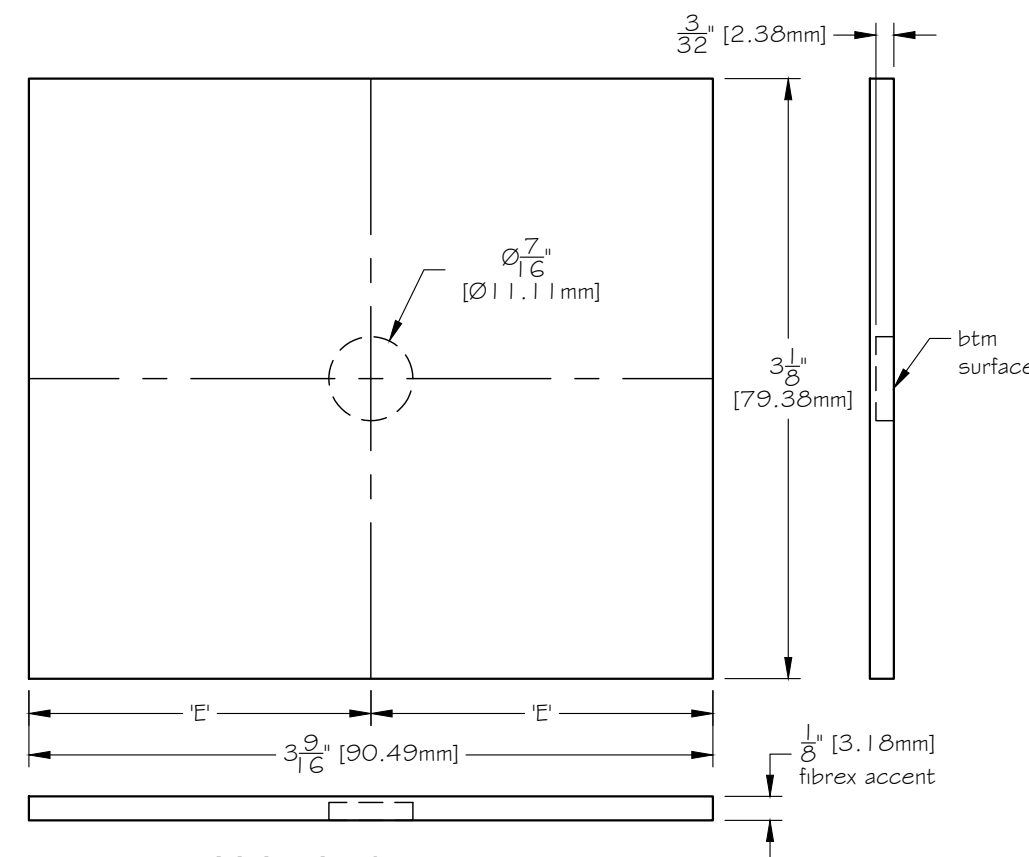

#MAZ3BGLH - triple bangle w/accnt & magnet 1/8" fibrex accent

- Cut $\frac{1}{8}$ " fibrex into $3\frac{9}{16}$ "W x $3\frac{1}{8}$ "D. Drill single $\frac{7}{16}$ "Diameter x $\frac{3}{32}$ "D circle in btm center. Strip Cover in fabric, leaving drilled circle on btm exposed. Hold for assembly.

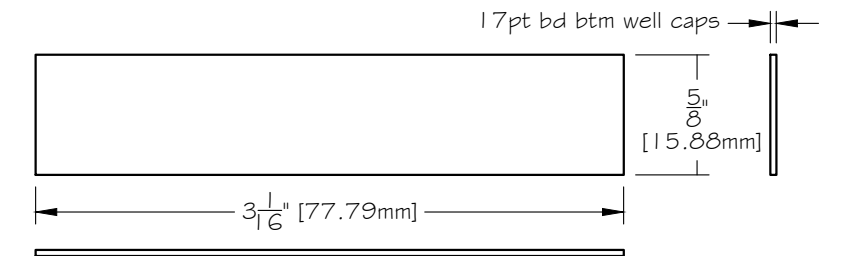

#MAZ3BGLH - triple bangle w/accnt & magnet 17pt bd btm well caps

- qty: 3 per display
Die-cut 17pt bd into $3\frac{1}{16}$ "W x $\frac{5}{8}$ "D. Hold for assembly.

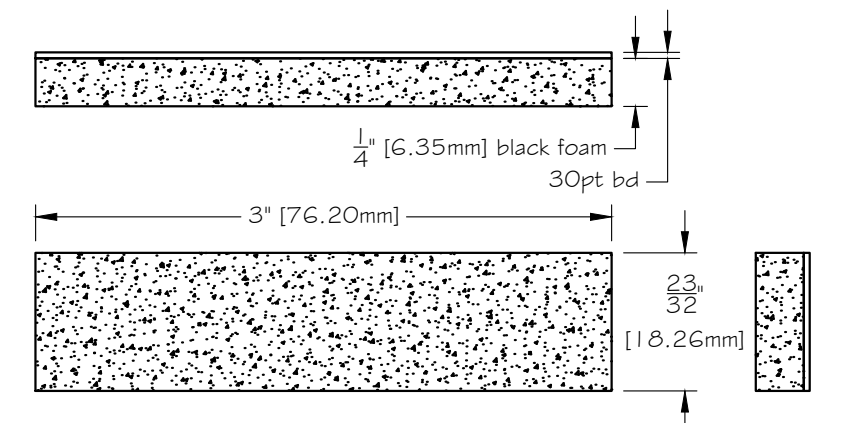

#MAZ3BGLH - triple bangle w/accnt & magnet 30pt bd + 1/4" black foam stuffing

- qty: 6 per display
Laminate $\frac{1}{4}$ " black foam to 30pt bd. Cut into 3"W x $\frac{3}{32}$ "D strips. Cover top down, leaving left/right sides raw. See right for pictorial. Hold for assembly.

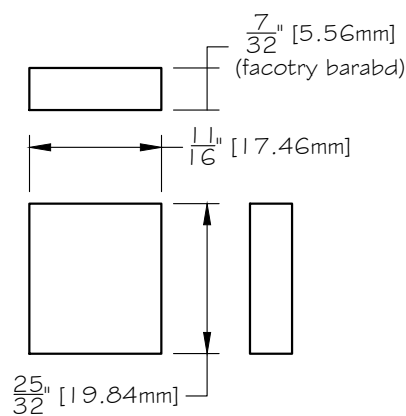
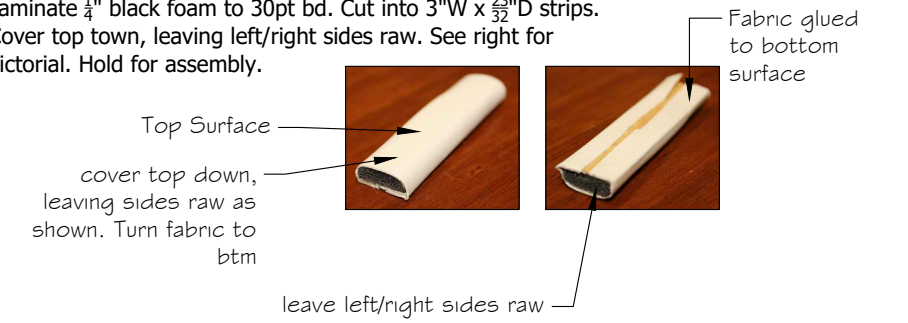

#MAZ3BGLH - triple bangle w/accnt & magnet 1/4" barabd channel plugs

- qty: 6 per display
Cut (6) pcs of $\frac{1}{4}$ " barabd into $\frac{1}{16}$ "W x $\frac{7}{32}$ "D. Hold for assembly.

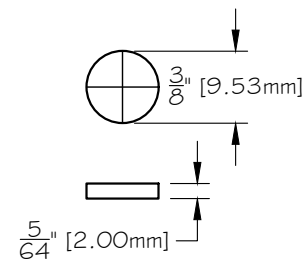

#MAZ3BGLH - triple bangle w/accnt & magnet 3/8" diameter magnet

- Use $\frac{3}{8}$ " diameter magnet (10mm x 2mm)

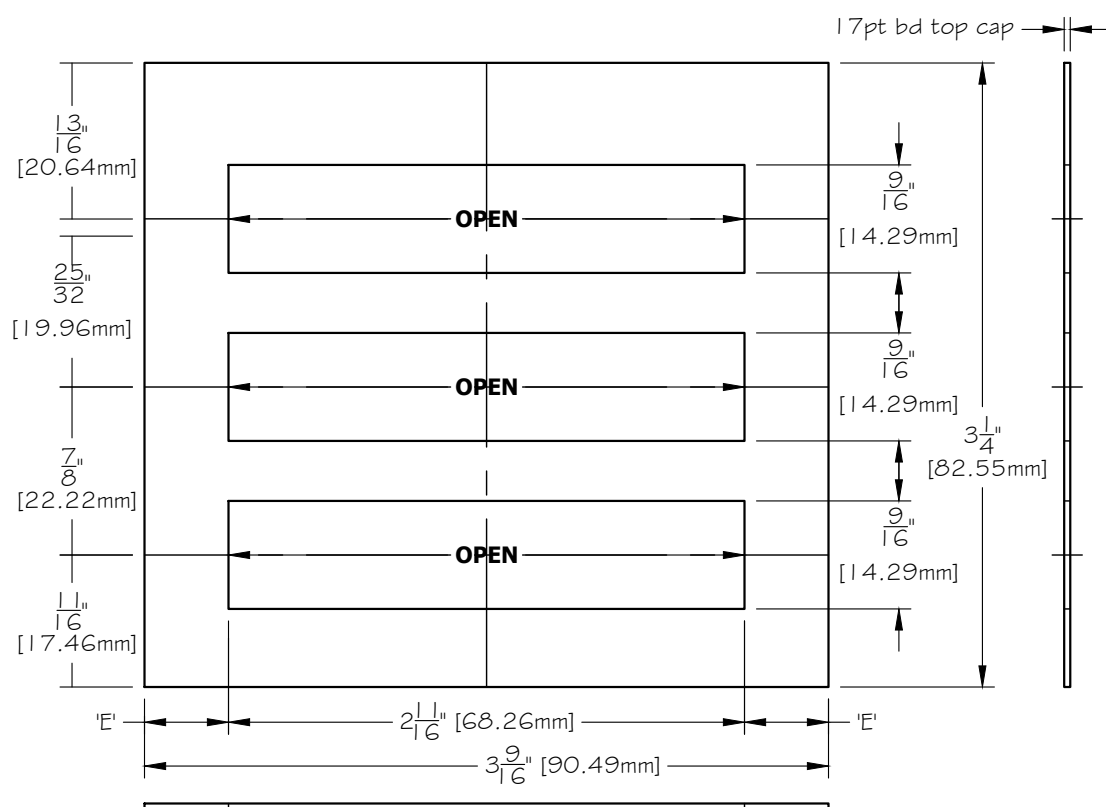

#MAZ3BGLH - triple bangle w/accnt & magnet 17pt bd top cap

- Die-cut 17pt bd to $3\frac{9}{16}$ "W x $3\frac{1}{8}$ "D with (3) $2\frac{1}{16}$ "W x $\frac{9}{16}$ "D bangle slots in location indicated above. Cover top down in fabric turning fabric into slots and btm of cap. Hold for assembly.

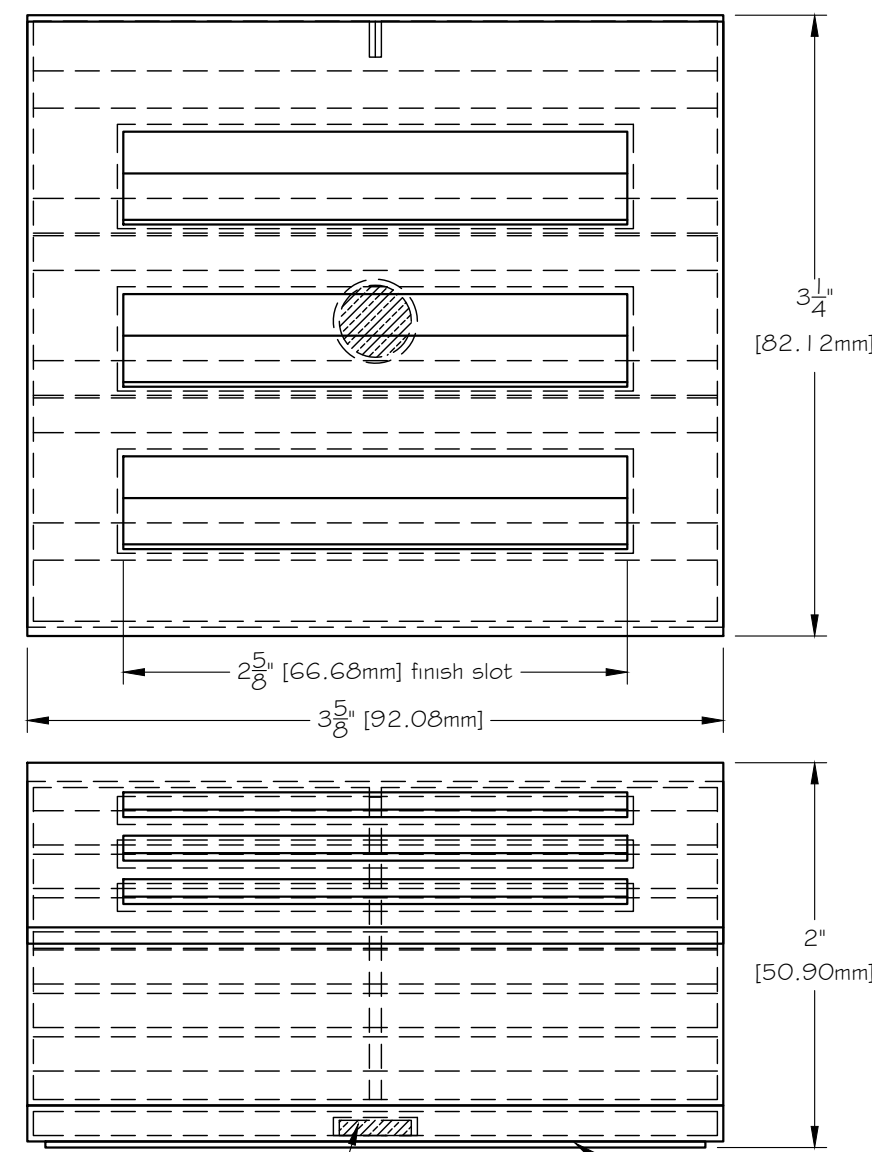

#MAZ3BGLH - Triple bangle w/accnt & magnet

finished dimension: $3\frac{5}{8}$ "W x $3\frac{1}{4}$ "D x 2"Ht

(See page 1 of 1 for barabd base assembly)

1. Centering all around, permanently glue covered top cap to top of covered barabd base.
2. Centering all around, permanently glue covered fibrex accent to btm of covered barabd base.
3. Permanently glue magnet into btm of accent in drilled circle, making sure magnet is flush to btm surface and not bulging out.
4. Finish with label paper laminated on 17pt bd on btm.

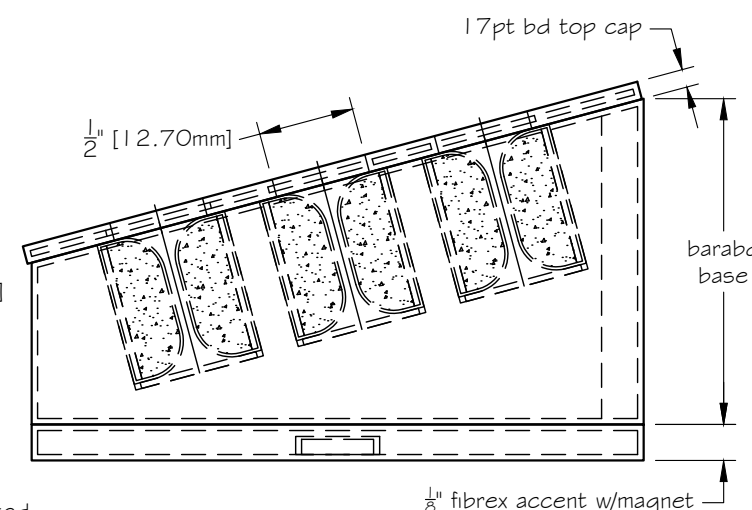

PROPRIETARY DOCUMENT
DESIGN EXCLUSIVE PROPERTY OF
BUFKOR
DESIGN NOT TO BE REPRODUCED
WITHOUT WRITTEN CONSENT.

All dimensions listed are raw. Test all pieces for correct fit and function.
Todas las medidas dadas son crudas. Probar todas las piezas para encaje y funcionamiento correcto.

PURPOSE:	SHEET OF
PRODUCTION DRAWING	3 OF 3
DESCRIPTION: MAZUCCHELLIS MAZ3BGLH - TRIPLE BANGLE W/ACCENT	DRAWING #: 15762
CUSTOMER, ADDRESS OR LOCATION: THE JEWELLERY GROUP	SCALE: 1" = 1"
STORE PLANNING AND CUSTOM DESIGN SERVICE	DATE: 09/22/14
EXECUTIVE OFFICES: 13101 56th COURT NORTH STE. 815 CLEARWATER, FLORIDA 33760 © 2014 BUFKOR INC.	SALESMAN: SJ
	DRAWN BY: SS

NOTICE: ALL PROPRIETARY DOCUMENT (INCLUDING ITS CONTENTS, IN WHOLE OR IN PART) IS LOANED TO BAILEE ON CONDITION THAT IT BE RETURNED ON DEMAND, AND THAT NO USE OR DISCLOSURE TO ANOTHER OR REPRODUCTION IN WHOLE OR IN PART, BE MADE OF IT, WITHOUT PRIOR WRITTEN PERMISSION BY A DULY AUTHORIZED OFFICER OF BUFKOR, INC., ITS EXCLUSIVE OWNER AND BAILEE.